

# Polycore Components

## Louvers

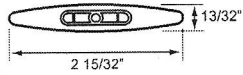

**2.5" ALUMINUM CORE LOUVER**  
PC2.5AL

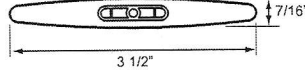

**3.5" ALUMINUM CORE LOUVER**  
PC3.5AL

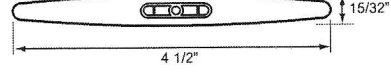

**4.5" ALUMINUM CORE LOUVER**  
PC4.5AL

## Stiles

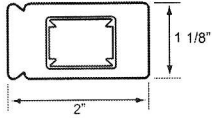

**ALUMINUM REINFORCED STILE**  
PC1AS

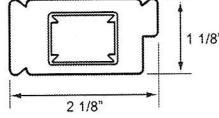

**RABBITTED STILE**  
PC1ASR

## Rails

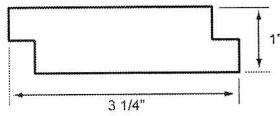

**DIVIDER RAIL**  
PC4DR

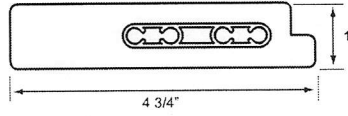

**ALUMINUM REINFORCED RAIL**  
PC1AR4

## Frames

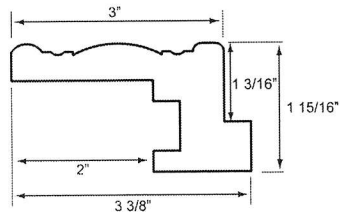

**LARGE Z-FRAME**  
PC4ZZF

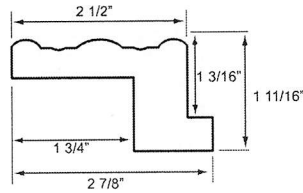

**MEDIUM Z-FRAME**  
PC3ZF

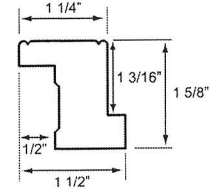

**SMALL Z-FRAME**  
PC2ZF

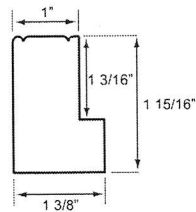

**L-FRAME**  
PC4LF

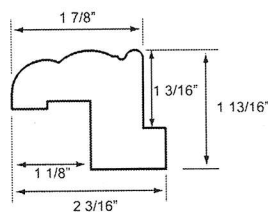

**MALIBU Z-FRAME**  
PC4MF

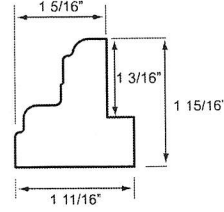

**T-FRAME**  
PC4TF

## Others

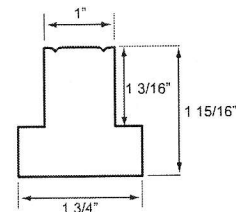

**T-POST**  
PC4TP

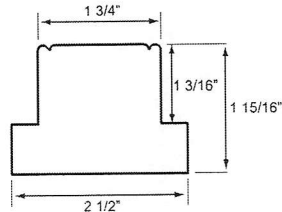

**LARGE T-POST**  
PC4LTP

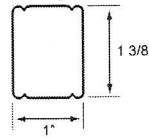

**BUILD OUT**  
PC4BO

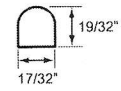

**TILT ROD**  
PC4TR